

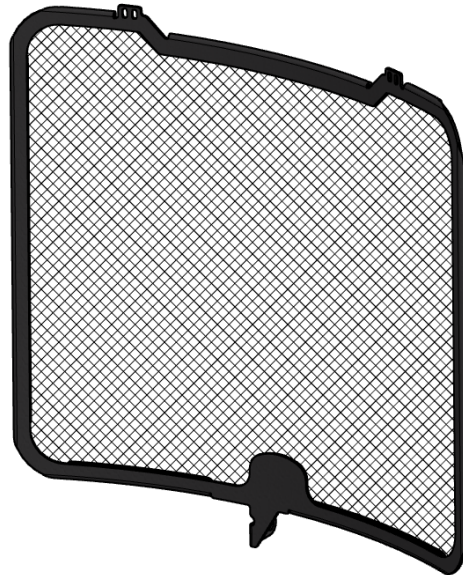

**Fitting Instructions for RAD0243BK Radiator Guard**  
**KAWASAKI NINJA ZX-6R 2019-**



**Please note that in cases where kits are packed with rubber washers holding the components onto the bolt – *the rubber washers should be thrown away!***

**THE PARTS SHOWN MAY BE REPRESENTATIVE ONLY (FOR CLARITY OF INSTRUCTIONS ONLY)**

**Digital copies of these instructions are available to download from [www.rg-racing.com](http://www.rg-racing.com)**

**TOOLS REQUIRED**

- Socket set to include 10mm socket & wrench.

**In This Kit There Should Be**

- 1 x Radiator Guard (RAD0243BK)**
- 3 x 100mm Lengths of self-adhesive Foam.**
- 4 x 2.5mm Cable Ties x 220mm Long**

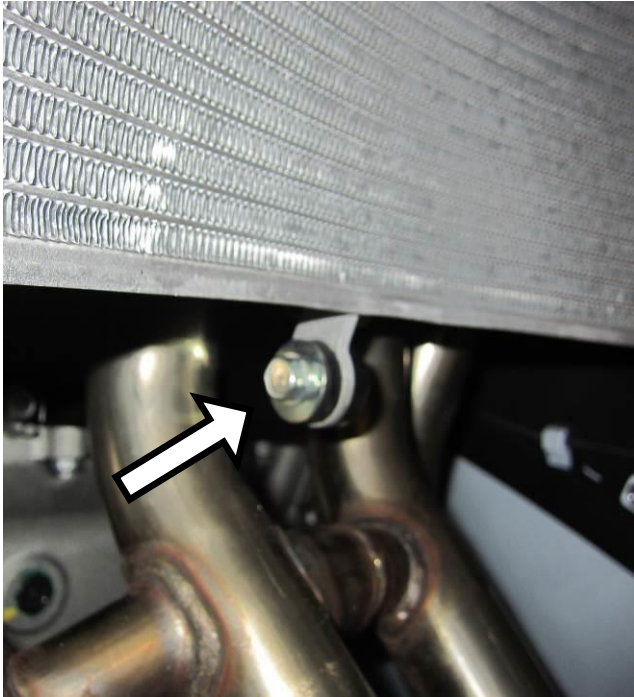

PICTURE 1



PICTURE 2

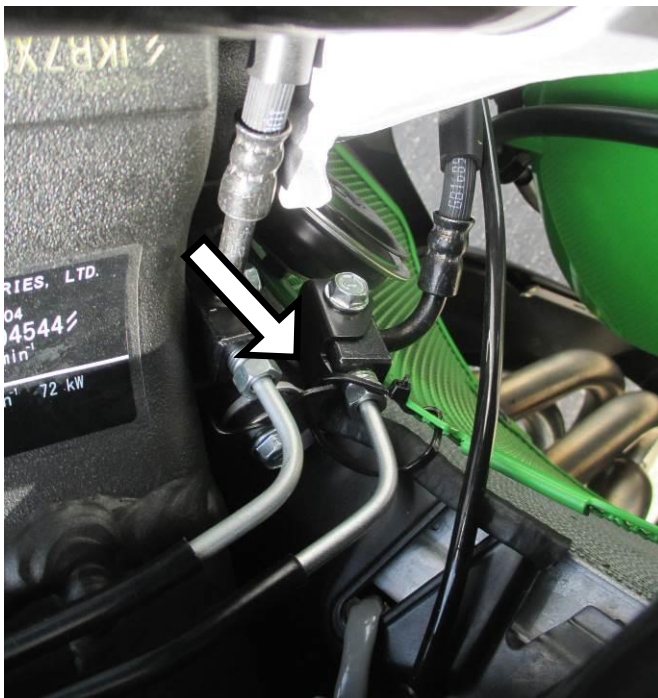

PICTURE 3

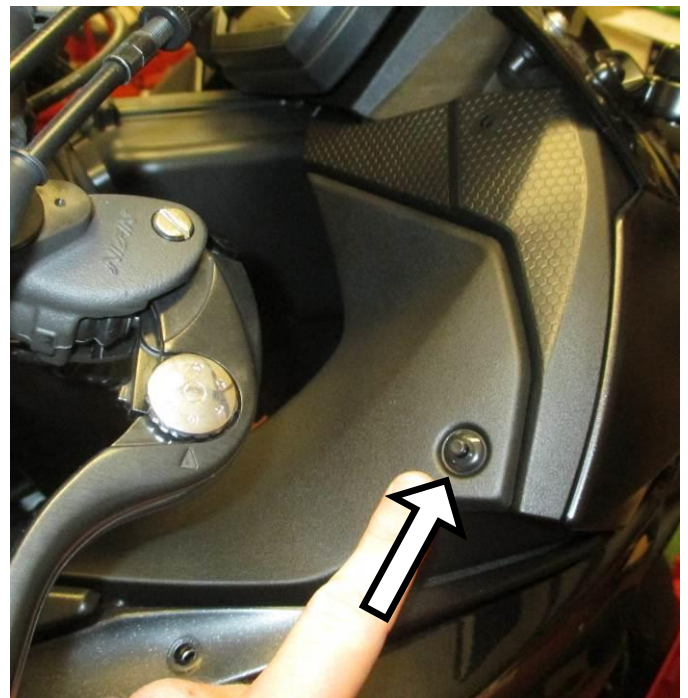

PICTURE 4



## **FITTING INSTRUCTIONS**

- To fit the radiator guard to the bike, first cut the foam strip provided into 10mm wide pieces and stick them to the back of the radiator guard frame, so that they will sit between the radiator guard and the radiator.
- Remove the lower radiator mounting bolt arrowed in **Picture 1**.
- Offer the radiator guard into position, ensuring that the abs block and any cables are clear of the radiator guard.
- Secure the radiator guard mounting to the lower radiator mount using the original bolt, **do not tighten fully at this stage**.
- Loosely secure the left-hand side cable tie around the cable retaining loop as shown in **Picture 2**.
- Secure the right-hand side cable tie around the abs block mounting bracket as shown in **Picture 3**.
- Fully tighten the left-hand side cable tie.
- If greater access is required to the cable tie mounts, remove the fairing panel arrowed in **Picture 4**.
- Now fully tighten the lower mount bolt to the specified torque.

ISSUE 2 08/07/2019 (DM)

### **CONSUMER NOTICE**

The catalogue description and any exhibition of samples are only broad indications of the Products and R&G may make design changes which do not diminish their performance or visual appeal and supplying them in such state shall conform to the order. The Buyer acknowledges no representation or warranty (other than as to title) has been given or will apply to the Products other than those in R&G's order or confirmation and the Buyer confirms it has chosen the Products as being of merchantable quality and suitable for its particular purposes. Where R&G fits the Products or undertakes other services it shall exercise reasonable skill and care and rectify any fault free of charge unless the workmanship has been disturbed. The Buyer is responsible for ensuring that the warranty on the motorcycle is not affected by the fitting of the Products. On return of any defective Products R&G shall at its option either supply a replacement or refund the purchase money but shall not be liable if the Products have been modified or used or maintained otherwise than in accordance with R&G's or manufacturer's instructions and good engineering practice or if the defect arises from accident or neglect. Other than identified above and subject to R&G not limiting its liability for causing death and personal injury, it shall not be liable for indirect or consequential loss and otherwise its liability shall be limited to the amounts paid by the Buyer for the Products or the fitting or service concerned. These terms do not affect the Buyer's statutory rights.

### **R&G RACING RETURNS POLICY (NON-FAULTY GOODS)**

Returns must be pre-authorized (if not pre-authorized the return will be rejected). Goods may only be returned direct to us if they were purchased direct from us (customer must prove if necessary). Otherwise to be returned to original vendor. Goods must be in re-sellable condition, in the opinion of R&G Racing. All returns are subject to a 25% restocking and handling fee (25% of the gross value exc. P&P – at the prevailing price at time of purchase). The customer must pay any and all carriage charges. No returns of discontinued products, unless within 14 days of purchase. This policy does not affect your statutory rights and does not refer to faulty goods.

R&G Racing

Unit 1, Shelley's Lane, East Worldham, Alton, Hampshire, GU34 3AQ

Tel: +44 (0)1420 89007 Fax: +44 (0)1420 87301 [www.rg-racing.com](http://www.rg-racing.com) Email: [info@rg-racing.com](mailto:info@rg-racing.com)



**NOTICE DE MONTAGE POUR RAD0243BK GRILLE DE PROTECTION RADIATEUR  
KAWASAKI NINJA ZX-6R 2019-**

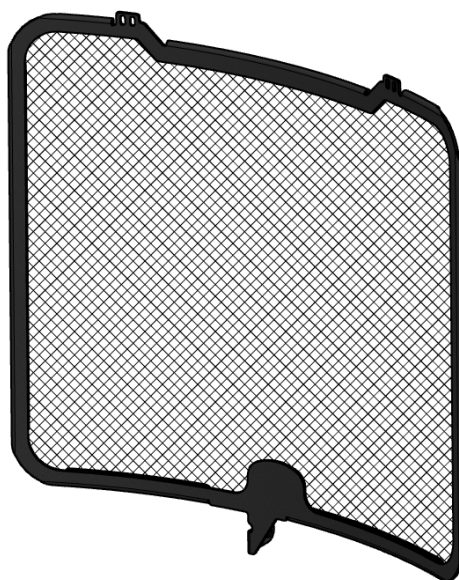
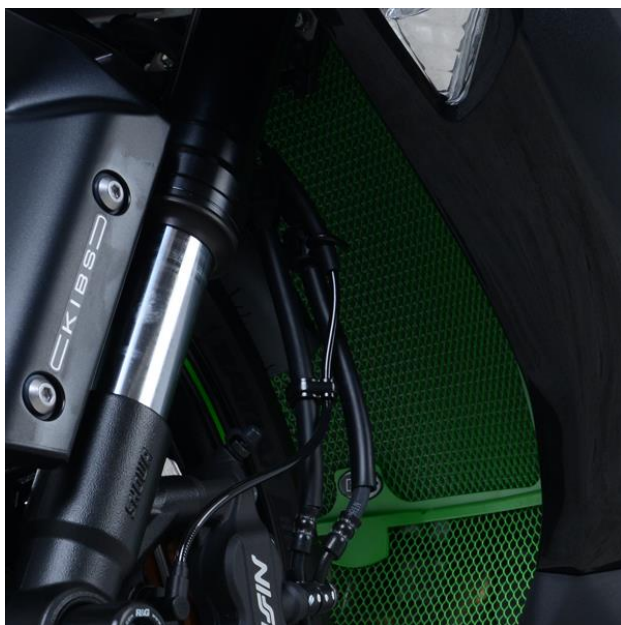

**Notez que si les kits sont emballés avec des rondelles en caoutchouc servant à tenir les composants, ces rondelles doivent être jetées !**

**LES PARTIES PRESENTÉES PEUVENT ETRE UNIQUEMENT REPRESENTATIVES (POUR LA CLARTE DES INSTRUCTIONS UNIQUEMENT)**

**Notice disponible au téléchargement sur [www.rg-racing.com](http://www.rg-racing.com)**

**OUTILS REQUIS**

- Clé à cliquet 10mm



**Le kit doit contenir :**  
**1 x Grille de protection radiateur (RAD0243BK)**  
**3 x 100mm Longueur de mousse autocollante.**  
**4 x 2.5mm Colliers de serrage x 220mm de Long**

### **NOTICE DE MONTAGE**

- Pour monter la grille de protection sur la moto, couper la mousse autocollante fournie en bandeaux de 10mm puis collez les au bas du cadre de protection radiateur, de façon à ce qu'ils se placent entre la grille de protection radiateur et le radiateur.
- Retirez le boulon de fixation inférieur du radiateur indiqué par la fleche sur la photo 1.
- Monter la protection radiateur en place en vous assurant que le bloc ABS et les câbles soient dégagés de la protection.
- Fixez le support de protection de radiateur au support de radiateur inférieur à l'aide du boulon d'origine. Ne serrez pas complètement à ce stade.
- Fixez sans serrer l'attache de câble du côté gauche autour de la boucle de retenue de câble, comme indiqué sur la photo 2.
- Fixez l'attache-câble du côté droit autour du support de montage du bloc ABS, comme indiqué sur la photo 3.
- Serrez à fond l'attache-câble du côté gauche.
- Si un accès plus important est requis aux fixations de serre-câbles, retirez le panneau de carénage fléché sur la photo 4.
- Now fully tighten the lower mount bolt to the specified torque.
- Serrez maintenant complètement le boulon de fixation inférieur à la valeur spécifiée.

ISSUE 2 08/07/2019 (DM)



**Montageanleitung für RAD0243BK Kühlerschutz**  
**KAWASAKI NINJA ZX-6R 2019-**

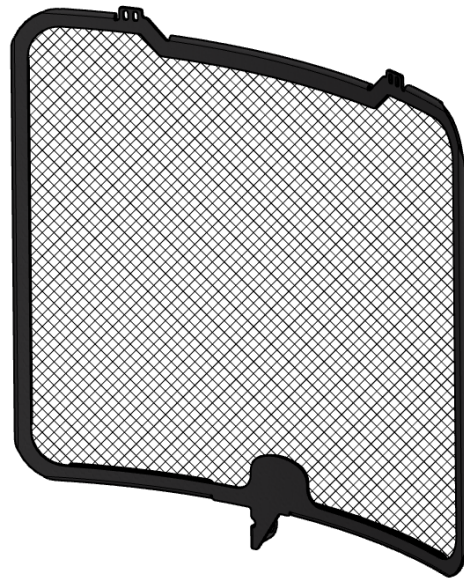

**Hinweis für Kits mit Plastikunterlegscheiben an den Schrauben – Diese Plastikunterlegscheiben werden nicht für den Einbau benötigt!**

**DIE ABGEBILDETEN TEILE DIENEN LEDIGLICH ZUR ERKLÄRUNG**

**Eine digitale Version dieser Montageanleitung kann auf folgender Seite heruntergeladen werden: [www.rg-racing.com](http://www.rg-racing.com)**

**SIE BENÖTIGEN FOLGENDES WERKZEUG**

- Satz Steckschlüssel mit 10mm Steckschlüssel

**Inhalt des Kits**

- 1 x Kühlerschutz (RAD0243BK)**
- 3 x 100mm selbstklebende Schaumstoffstreifen**
- 4 x 2,5 mm Kabelbinder x 220mm Länge**



## **MONTAGEANLEITUNG**

- Um den Kühlerschutz am Motorrad zu montieren, schneiden Sie zuerst die mitgelieferten Schaumstoffstreifen in 10 mm breite Streifen und kleben Sie diese auf der Rückseite des Kühlerschutzrahmens, so dass sie zwischen dem Kühlerschutz und dem Kühler angebracht sind.
- Entfernen Sie die untere Montageschraube für den Kühler, die in **Abbildung 1** gekennzeichnet ist.
- Den Kühlerschutz in Position bringen – bitte darauf achten, dass der ABS Block und die Kabel den Kühler nicht berühren.
- Die Kühlerschutz-Montagehalterung an der unteren Kühlerhalterung mit der Originalschraube sichern - **zu diesem Zeitpunkt nicht festziehen.**
- Den Kabelbinder für die linke Seite lose um die Halterungsschleife binden wie in **Abbildung 2** abgebildet.
- Den Kabelbinder für die rechte Seite um die Halterung für den ABS-Block binden wie in **Abbildung 3** abgebildet.
- Den Kabelbinder für die linke Seite festziehen.
- Falls einen besseren Zugang zu den Kabelbinder-Halterungen benötigt wird, entfernen Sie das Verkleidungsteil, das in **Abbildung 4** mit einem Pfeil markiert ist.
- Die untere Montageschraube mit dem empfohlenen Anzugsdrehmoment nun befestigen.

AUSGABE 2 08/07/2019 (DM)